

Public Protection/Licensing
222 Upper Street, London
N1 1XR

Report of: Director of Community Safety, Resilience and Community

Meeting of: Licensing Sub-Committee

Date: 07/09/2023

Ward(s): Bunhill

[Redacted]

Subject:

PREMISES LICENCE NEW APPLICATION

Re: Naar, 94 Old Street, London EC1

1. Synopsis

1.1. This is an application for a new premise licence under the Licensing Act 2003.

1.2. The new application is to allow:

- The provision of late night refreshment from 23:00 until 00:00 Sunday to Thursday and from 23:00 until 03:00 Friday and Saturday
- Opening hours of the premises from 11:00 until 00:00 Sunday to Thursday and from 11:00 until 03:00 Friday and Saturday
- Note: Late Night Refreshment is the provision of hot food after 23:00 and before 05:00. There is no sale or supply of alcohol at any time at the premises.

1.3. Relevant Representations:

Licensing Authority	Yes
---------------------	-----

Metropolitan Police	Yes - Conditions Suggested
Noise	No - Conditions Agreed
Health and Safety	No
Trading Standards	No
Public Health	No
Safeguarding Children	No
London Fire Brigade	No
Local residents	Yes: Five resident representations
Other bodies	No:

2. Recommendations

- 2.1. To determine the application for a new premises licence under Section 17 of the Licensing Act 2003.
- 2.2. This premises is located in the Bunhill Cumulative Impact Area therefore the Licensing Sub-Committee will need to consider Licensing Policy 3, which states that there is a presumption of refusal unless the Sub-Committee is satisfied that there will be no adverse cumulative impact on the licensing objectives.
- 2.3. The application form addresses the Cumulative Impact Area and Policy by suggesting a number of conditions in the Operating Schedule. The applicants further endorse these conditions by accepting conditions suggested by the Police and Islington Council's Noise Service.
- 2.4. If the Licensing Sub-Committee grants the application it should be subject to:
 - i. Conditions prepared by the Licensing Officer which are consistent with the Operating Schedule (see appendix 5); and
 - ii. Any conditions deemed appropriate by the Licensing Sub-Committee to promote the four licensing objectives.

3. Background

- 3.1 The application describes the premises as being a restaurant/take away.

- 3.2 The property already benefits from a premises. Licence, which has been in place at this property since 2006. This licence is for the following;
- The provision of late night refreshment from 23:00 until 02:00 Sunday to Thursday and from 23:00 until 03:00
 - No specified opening hours
 - The licence contains two out of date conditions
- 3.3 Upon application, the applicant should have been advised of the existing licence and given assistance in making the application to transfer onto the licence.
- 3.4 Discussions with the applicants have resulted in the business partner of the applicant making an application to transfer the existing licence into his name. Note: This applicant would have made the application to transfer in his business name, however, is abroad at this time.
- 3.5 The application received seven letters of representation from local residents. These were found the Licensing Authority (LA), the Licensing Police and five residents local to the premises. The representations from the LA and Police were based on policy.
- 3.6 On receipt of the representations, the applicant wrote to the representors to advise them of the nature of the application.
- 3.7 The applicant has accepted conditions requested with the Police and Islington's Noise Service.

4. Implications

4.1. Financial Implications

- 4.1.1. The Head of Finance reports that the applicant has paid the application fee of £190.00. Should the application be refused, the fee is not refundable.

4.2. Legal Implications

- 4.2.1. The legal implications are set out in Paragraph 2.
- 4.2.2. Legal advice will be provided at the meeting of the Licensing Sub-Committee as necessary.

4.3. Environmental Implications and contribution to achieving a net zero carbon Islington by 2030

- 4.3.1. The Licensing Sub-Committee need to consider the impacts that the proposals will have on the environment. An impact is defined as any change to the environment,

whether positive or negative, wholly or partially resulting from Council activities. Almost all human activity has some impact on the environment, and it is very unlikely that any activity will not have any implications.

4.4. Equalities Impact Assessment

4.4.1. The council must, in the exercise of its functions, have due regard to the need to eliminate discrimination, harassment and victimisation, and to advance equality of opportunity, and foster good relations, between those who share a relevant protected characteristic and those who do not share it (section 149 Equality Act 2010). The council has a duty to have due regard to the need to remove or minimise disadvantages, take steps to meet needs, in particular steps to take account of disabled persons' disabilities, and encourage people to participate in public life. The council must have due regard to the need to tackle prejudice and promote understanding.

4.4.2. An Equalities Impact Assessment is not required in relation to this report, because this is a decision relating to a Premises Licence application under the Licensing Act 2003.

4.5. Planning implications

4.5.1 The Planning and Development Section have the following comments in relation to the licence application.

The property is not listed but is located within the St Luke's Conservation Area.

The ground floor and basement have been used since at least 1993 as a mixed restaurant and takeaway use since and this would be the lawful use.

There are no planning conditions restricting opening hours or any current planning enforcement cases relating to the property.

5. Conclusion and reasons for recommendations

5.1. That the Licensing Sub-Committee determines this application.

Appendices:

- Appendix 1: The application form;
- Appendix 2: Existing licence at the Premises;
- Appendix 3: Representations;
- Appendix 4: Applicants response to the representations;
- Appendix 5: Suggested conditions and map of premises location.

Report author: Licensing Service

Tel: 020 75027 3031

E-mail: licensing@islington.gov.uk

* required information

Section 1 of 21

You can save the form at any time and resume it later. You do not need to be logged in when you resume.

System reference

Not Currently In Use

This is the unique reference for this application generated by the system.

Your reference

You can put what you want here to help you track applications if you make lots of them. It is passed to the authority.

Are you an agent acting on behalf of the applicant?

Yes No

Put "no" if you are applying on your own behalf or on behalf of a business you own or work for.

Applicant Details

* First name

Abdullah

* Family name

Mohammedi

* E-mail

Main telephone number

Include country code.

Other telephone number

Indicate here if you would prefer not to be contacted by telephone

Are you:

- Applying as a business or organisation, including as a sole trader
 Applying as an individual

A sole trader is a business owned by one person without any special legal structure. Applying as an individual means you are applying so you can be employed, or for some other personal reason, such as following a hobby.

Applicant Business

Is your business registered in the UK with Companies House? Yes No

Note: completing the Applicant Business section is optional in this form.

Registration number

Business name

Naarfoood limited

If your business is registered, use its registered name.

VAT number

Put "none" if you are not registered for VAT.

Legal status

Private Limited Company

Continued from previous page...

Your position in the business

Home country

The country where the headquarters of your business is located.

Registered Address

Address registered with Companies House.

Building number or name

Street

District

City or town

County or administrative area

Postcode

Country

Section 2 of 21

PREMISES DETAILS

I/we, as named in section 1, apply for a premises licence under section 17 of the Licensing Act 2003 for the premises described in section 2 below (the premises) and I/we are making this application to you as the relevant licensing authority in accordance with section 12 of the Licensing Act 2003.

Premises Address

Are you able to provide a postal address, OS map reference or description of the premises?

- Address OS map reference Description

Postal Address Of Premises

Building number or name

Street

District

City or town

County or administrative area

Postcode

Country

Further Details

Telephone number

Non-domestic rateable value of premises (£)

Section 3 of 21

APPLICATION DETAILS

In what capacity are you applying for the premises licence?

- An individual or individuals
- A limited company / limited liability partnership
- A partnership (other than limited liability)
- An unincorporated association
- Other (for example a statutory corporation)
- A recognised club
- A charity
- The proprietor of an educational establishment
- A health service body
- A person who is registered under part 2 of the Care Standards Act 2000 (c14) in respect of an independent hospital in Wales
- A person who is registered under Chapter 2 of Part 1 of the Health and Social Care Act 2008 in respect of the carrying on of a regulated activity (within the meaning of that Part) in an independent hospital in England
- The chief officer of police of a police force in England and Wales

Confirm The Following

- I am carrying on or proposing to carry on a business which involves the use of the premises for licensable activities
- I am making the application pursuant to a statutory function
- I am making the application pursuant to a function discharged by virtue of Her Majesty's prerogative

Section 4 of 21

NON INDIVIDUAL APPLICANTS

Provide name and registered address of applicant in full. Where appropriate give any registered number. In the case of a partnership or other joint venture (other than a body corporate), give the name and address of each party concerned.

Non Individual Applicant's Name

Name

Details

Registered number (where applicable)

Description of applicant (for example partnership, company, unincorporated association etc)

Continued from previous page...

Address

Building number or name	<input type="text"/>
Street	<input type="text"/>
District	<input type="text"/>
City or town	<input type="text"/>
County or administrative area	<input type="text"/>
Postcode	<input type="text"/>
Country	<input type="text"/>

Contact Details

E-mail	<input type="text"/>
Telephone number	<input type="text"/>
Other telephone number	<input type="text"/>
* Date of birth	<input type="text"/> / <input type="text"/> / <input type="text"/>
	dd mm yyyy
* Nationality	<input type="text"/>

[Documents that demonstrate entitlement to work in the UK](#)

Section 5 of 21

OPERATING SCHEDULE

When do you want the premises licence to start? / /

dd mm yyyy

If you wish the licence to be valid only for a limited period, when do you want it to end / /

dd mm yyyy

Provide a general description of the premises

For example the type of premises, its general situation and layout and any other information which could be relevant to the licensing objectives. Where your application includes off-supplies of alcohol and you intend to provide a place for consumption of these off- supplies you must include a description of where the place will be and its proximity to the premises.

It will be food only and no Alcohol in the take away ,Take away need to be open late night and only 20 people at max will be in take away at one time

Continued from previous page...

If 5,000 or more people are expected to attend the premises at any one time, state the number expected to attend

Section 6 of 21

PROVISION OF PLAYS

[See guidance on regulated entertainment](#)

Will you be providing plays?

- Yes No

Section 7 of 21

PROVISION OF FILMS

[See guidance on regulated entertainment](#)

Will you be providing films?

- Yes No

Section 8 of 21

PROVISION OF INDOOR SPORTING EVENTS

[See guidance on regulated entertainment](#)

Will you be providing indoor sporting events?

- Yes No

Section 9 of 21

PROVISION OF BOXING OR WRESTLING ENTERTAINMENTS

[See guidance on regulated entertainment](#)

Will you be providing boxing or wrestling entertainments?

- Yes No

Section 10 of 21

PROVISION OF LIVE MUSIC

[See guidance on regulated entertainment](#)

Will you be providing live music?

- Yes No

Section 11 of 21

PROVISION OF RECORDED MUSIC

[See guidance on regulated entertainment](#)

Will you be providing recorded music?

- Yes No

Section 12 of 21

PROVISION OF PERFORMANCES OF DANCE

[See guidance on regulated entertainment](#)

Will you be providing performances of dance?

Continued from previous page...

Section 13 of 21

PROVISION OF ANYTHING OF A SIMILAR DESCRIPTION TO LIVE MUSIC, RECORDED MUSIC OR PERFORMANCES OF DANCE

[See guidance on regulated entertainment](#)

Will you be providing anything similar to live music, recorded music or performances of dance?

Yes No

Section 14 of 21

LATE NIGHT REFRESHMENT

Will you be providing late night refreshment?

Yes No

Standard Days And Timings

MONDAY

Start

End

Start

End

Give timings in 24 hour clock.
(e.g., 16:00) and only give details for the days
of the week when you intend the premises
to be used for the activity.

TUESDAY

Start

End

Start

End

WEDNESDAY

Start

End

Start

End

THURSDAY

Start

End

Start

End

FRIDAY

Start

End

Start

End

SATURDAY

Start

End

Start

End

SUNDAY

Start

End

Start

End

Continued from previous page...

Will the provision of late night refreshment take place indoors or outdoors or both?

- Indoors Outdoors Both

Where taking place in a building or other structure tick as appropriate. Indoors may include a tent.

State type of activity to be authorised, if not already stated, and give relevant further details, for example (but not exclusively) whether or not music will be amplified or unamplified.

State any seasonal variations

For example (but not exclusively) where the activity will occur on additional days during the summer months.

Non-standard timings. Where the premises will be used for the supply of late night refreshments at different times from those listed in the column on the left, list below

For example (but not exclusively), where you wish the activity to go on longer on a particular day e.g. Christmas Eve.

Section 15 of 21

SUPPLY OF ALCOHOL

Will you be selling or supplying alcohol?

- Yes No

PROPOSED DESIGNATED PREMISES SUPERVISOR CONSENT

How will the consent form of the proposed designated premises supervisor be supplied to the authority?

- Electronically, by the proposed designated premises supervisor
 As an attachment to this application

Reference number for consent form (if known)

If the consent form is already submitted, ask the proposed designated premises supervisor for its 'system reference' or 'your reference'.

Section 16 of 21

ADULT ENTERTAINMENT

Continued from previous page...

Highlight any adult entertainment or services, activities, or other entertainment or matters ancillary to the use of the premises that may give rise to concern in respect of children

Give information about anything intended to occur at the premises or ancillary to the use of the premises which may give rise to concern in respect of children, regardless of whether you intend children to have access to the premises, for example (but not exclusively) nudity or semi-nudity, films for restricted age groups etc gambling machines etc.

Section 17 of 21

HOURS PREMISES ARE OPEN TO THE PUBLIC

Standard Days And Timings

MONDAY

Start

End

Start

End

Give timings in 24 hour clock.
(e.g., 16:00) and only give details for the days
of the week when you intend the premises
to be used for the activity.

TUESDAY

Start

End

Start

End

WEDNESDAY

Start

End

Start

End

THURSDAY

Start

End

Start

End

FRIDAY

Start

End

Start

End

SATURDAY

Start

End

Start

End

SUNDAY

Start

End

Start

End

State any seasonal variations

For example (but not exclusively) where the activity will occur on additional days during the summer months.

Continued from previous page...

Non standard timings. Where you intend to use the premises to be open to the members and guests at different times from those listed in the column on the left, list below

For example (but not exclusively), where you wish the activity to go on longer on a particular day e.g. Christmas Eve.

Section 18 of 21

LICENSING OBJECTIVES

Describe the steps you intend to take to promote the four licensing objectives:

a) General – all four licensing objectives (b,c,d,e)

List here steps you will take to promote all four licensing objectives together.

making sure having the competent staff always

b) The prevention of crime and disorder

have cctv on and cover the take away fully

c) Public safety

keep the fire exit always clear and the sings are illuminated ,fire extinguisher be present in the premises

d) The prevention of public nuisance

customers should quietly

e) The protection of children from harm

we sale only food no alcohol and allergies will be asked

Continued from previous page...

Address

Building number or name	<input type="text"/>
Street	<input type="text"/>
District	<input type="text"/>
City or town	<input type="text"/>
County or administrative area	<input type="text"/>
Postcode	<input type="text"/>
Country	<input type="text" value="United Kingdom"/>

DECLARATION

[Applicable to individual applicants only, including those in a partnership which is not a limited liability partnership] I understand I am not entitled to be issued with a licence if I do not have the entitlement to live and work in the UK (or if I am subject to a condition preventing me from doing work relating to the carrying on of a licensable activity) and that my licence will become invalid if I cease to be entitled to live and work in the UK (please read guidance note 15).

The DPS named in this application form is entitled to work in the UK (and is not subject to conditions preventing him or her from doing work relating to a licensable activity) and I have seen a copy of his or her proof of entitlement to work, if appropriate (please see note 15)

Ticking this box indicates you have read and understood the above declaration

This section should be completed by the applicant, unless you answered "Yes" to the question "Are you an agent acting on behalf of the applicant?"

* Full name	<input type="text"/>
* Capacity	<input type="text"/>
Date (dd/mm/yyyy)	<input type="text"/>

Once you're finished you need to do the following:

1. Save this form to your computer by clicking file/save as...
2. Go back to <https://www.gov.uk/apply-for-a-licence/premises-licence/islington/apply-1> to upload this file and continue with your application.

Don't forget to make sure you have all your supporting documentation to hand.

IT IS AN OFFENCE LIABLE TO SUMMARY CONVICTION TO A FINE OF ANY AMOUNT UNDER SECTION 158 OF THE LICENSING ACT 2003, TO MAKE A FALSE STATEMENT IN OR IN CONNECTION WITH THIS APPLICATION

IT IS AN OFFENCE UNDER SECTION 24B OF THE IMMIGRATION ACT 1971 FOR A PERSON TO WORK WHEN THEY KNOW, OR HAVE REASONABLE CAUSE TO BELIEVE, THAT THEY ARE DISQUALIFIED FROM DOING SO BY REASON OF THEIR IMMIGRATION STATUS. THOSE WHO EMPLOY AN ADULT WITHOUT LEAVE OR WHO IS SUBJECT TO CONDITIONS AS TO EMPLOYMENT WILL BE LIABLE TO A CIVIL PENALTY UNDER SECTION 15 OF THE IMMIGRATION, ASYLUM AND NATIONALITY ACT 2006 AND PURSUANT TO SECTION 21 OF THE SAME ACT, WILL BE COMMITTING AN OFFENCE WHERE THEY DO SO IN THE KNOWLEDGE, OR WITH REASONABLE CAUSE TO BELIEVE, THAT THE EMPLOYEE IS DISQUALIFIED



**PREMISES LICENCE
LICENSING ACT 2003**

Premises licence number	LN/3712-170615	Date of original grant*	24 November 2005
--------------------------------	----------------	--------------------------------	------------------

**An annual fee associated with this licence is to be paid on the anniversary of the original grant date.*

Premises licence number	LN/3712-170615		
Postal address of premises, or if none, ordnance survey map reference or description	<p align="center">BEST TURKISH KEBAB 94 OLD STREET</p>		
Post town	London	Post code	EC1V 9AY
Telephone number	020 7251 0536		

Where the licence is time limited the dates
Not Applicable

Licensable activities authorised by the licence
For the Ground Floor
<ul style="list-style-type: none"> The provision of late night refreshment

The times the licence authorises the carrying out of licensable activities																																			
Delete any that do not apply																																			
<ul style="list-style-type: none"> The provision of late night refreshment: <table border="0"> <tr> <td>Monday</td> <td>23.00</td> <td>to</td> <td>02.00</td> <td>the following day</td> </tr> <tr> <td>Tuesday</td> <td>23.00</td> <td>to</td> <td>02.00</td> <td>the following day</td> </tr> <tr> <td>Wednesday</td> <td>23.00</td> <td>to</td> <td>02.00</td> <td>the following day</td> </tr> <tr> <td>Thursday</td> <td>23.00</td> <td>to</td> <td>02.00</td> <td>the following day</td> </tr> <tr> <td>Friday</td> <td>23.00</td> <td>to</td> <td>03.00</td> <td>the following day</td> </tr> <tr> <td>Saturday</td> <td>23.00</td> <td>to</td> <td>03.00</td> <td>the following day</td> </tr> <tr> <td>Sunday</td> <td>23.00</td> <td>to</td> <td>02.00</td> <td>the following day</td> </tr> </table> 	Monday	23.00	to	02.00	the following day	Tuesday	23.00	to	02.00	the following day	Wednesday	23.00	to	02.00	the following day	Thursday	23.00	to	02.00	the following day	Friday	23.00	to	03.00	the following day	Saturday	23.00	to	03.00	the following day	Sunday	23.00	to	02.00	the following day
Monday	23.00	to	02.00	the following day																															
Tuesday	23.00	to	02.00	the following day																															
Wednesday	23.00	to	02.00	the following day																															
Thursday	23.00	to	02.00	the following day																															
Friday	23.00	to	03.00	the following day																															
Saturday	23.00	to	03.00	the following day																															
Sunday	23.00	to	02.00	the following day																															

The opening hours of the premises:
Not specified

Where the licence authorises supplies of alcohol whether these are on and/or off supplies
Not Applicable

Name, (registered) address, telephone number and e-mail (where relevant) of holder of premises licence

Niyazi Sahin



Registered number of holder, for example company number, charity number (where applicable)

Not Applicable

Name, address and telephone number of designated premises supervisor where the premises licence authorises the supply of alcohol

Not Applicable

Personal licence number and issuing authority of personal licence held by designated premises supervisor where the premises licence authorises the supply of alcohol

Not Applicable

Islington Council

Public Protection Division

222 Upper Street

London

N1 1XR

Tel: 020 7527 3031/3803

Email: licensing@islington.gov.uk

Service Manager (Commercial)

Date of Issue

Annex 1 - Mandatory conditions

Annex 2 - Conditions consistent with the Operating Schedule

1. The licence shall be subject to the Council's standard conditions for Night Cafes
2. The maximum number of persons (including staff) permitted on the premises at any one time shall not exceed 15 on the ground floor.

Annex 3 - Conditions attached after a hearing by the licensing authority

Annex 4 – Plans

Reference Number: LBI 88597 Dated: 20/07/05

Licence

Licensing Authority Representation**Licensing Act 2003**

Application for a new premises licence in respect of:

NAAR, 94 Old Street, London EC1V 9AY

Licensable activities and timings applied for are to provide late night refreshment, on the premises from 2300 to 0300 Fridays and Saturdays and to Midnight Sunday to Thursdays.

The grounds for the representation are:

Public nuisance

Prevention of crime and disorder

Licensing Policy Considerations

Licensing Policy 6 - Licensing Hours

Licensing Policy 22 - Noise associated with licensable activities.

Issues of Concern

The applicant has not put forward any mitigation or information in the operating schedule to demonstrate that these premises would not have a negative impact in an area saturated with outlets for take away and delivery of food.

Licensing Policy 6 - Licensing Hours- The hours applied for are outside of the recommended policy hours for premises selling hot food and drink supplied by takeaway and fast-food premises, which is Sundays to Thursday 11pm to midnight and on Fridays and Saturdays 11pm to 1am.

Licensing Policy 22 - The Licensing Authority is committed to protecting the amenity of residents and businesses in the vicinity of licensed premises, particularly when late hours have been sought. Where relevant representations are received, the Licensing Authority will impose appropriate restrictions and controls on the premises licence to prevent public nuisance and undue disturbance to residents from licensed premises.

The applicant has applied on the form for provision of late-night refreshment on the premises, however, then mentions deliveries will be for food only.

It is not clear from the application where delivery drivers would wait or where they would pick up orders. The site is in a residential and commercial area with several residents' homes nearby. In Islington there is growing concern regarding delivery drivers causing anti-social behaviour and noise, late at night and in the early hours.

Recommendations

The Licensing Authority suggests that the Committee consider the effect of delivery drivers in the local area and ask that all deliveries be by non-motorised vehicles, there should be a plan of where riders would wait and pick up deliveries and, that the management of the premises monitor the behaviour of the drivers and operate a procedure for taking action on any drivers causing anti-social behaviour.

The Licensing Authority recommends that the Licensing Sub Committee consider the application and the lack of information in the operating schedule, bearing in mind that the premises could attract customers from late night drinking premises in the area, who may loiter rather than leave the area. Consider any resident's representations, any conditions suggested by the Council's Pollution Team and the Police and Islington Council's Licensing Policy.

Terrie Lane

Licensing Manager

Public Protection Division

0207 527 3031

licensing@islington.gov.uk

09/08/2023



Abdullah Mohammedi
Naar Food Ltd
94 Old Street
London EC1V 9AY

Islington Police Licensing Team,
Islington Police Station,
2 Tolpuddle Street,
London N1 0YY

Our ref: WK/230018568 &
NIH231760
25th July 2023

Dear Abdullah,

PREMISES – NAAR , 94 OLD STREET , ISLINGTON , LONDON EC1V 9AY

Thank you for your new Late Night Refreshment premises licence application regarding the above premises. I understand from Mahrous who I met with on Friday that your efforts to secure the old licence with the better than current framework hours are continuing.

In the meantime please accept this e-mail as my initial representation for this application.

To that end there are 8 conditions which I deem appropriate in the circumstances that I would expect to see included in your application for a late night refreshment licence for this premises.

I would suggest that the current offerings in your application be ignored and be dispensed with and the following specified as replacements for the ones initially offered.

These conditions should not affect the intended use or operating policy I believe and should be considered as good practice in line with police expectations and the Statement of Licensing Policy 2023-2028 as published by Islington Council on their own website if you aren't already familiar with it. It is where you can find the current framework hours for late night refreshment licences also.

1) CCTV shall be installed, operated, and maintained, to function all times that the premises is open for licensable activities. Said CCTV will comply with the following criteria:

(a) The licensee will ensure that the system is checked every two weeks to ensure that the system is working properly and that the date and time are correct.

- (b) A record of these checks, showing the date and name of the person checking, will be kept and made available to the police or other authorised officer on request;
- (c) The Police will be informed if the system will not be operating for longer than one day of business for any reason;
- (d) One camera will show a close-up of the entrance to the premises, to capture a clear, full length image of anyone entering;
- (e) The system will provide full coverage of the interior of the premises and any exterior part of the premises accessible to the public;
- (f) The system will record in real time and recordings will be date and time stamped;
- (g) At all times during operating hours, there will be at least 1 member of staff on the premises who can operate the system sufficiently to allow Police or authorised Council officers to view footage on request.
- (h) Recordings will be kept for a minimum of 31 days and downloaded footage will be provided free of charge to the police or other authorised officers on request (subject to the Data Protection Act 2018) within 24 hours of any request .

(i) Signage stating that CCTV is in operation will be clearly and prominently displayed at the premises.

(j) The use of CCTV at the premises shall be registered with the Information Commissioners Office [ICO].

2) A premises incident log or book shall be kept at the premises, and made available upon request to the police or an authorised officer, which will record:

- (a) Any and all allegations of crime and/or disorder reported at the venue;
- (b) Any and all complaints received by any party;
- (c) Any faults in the CCTV system;
- (d) Any visit by a relevant authority or emergency service;
- (e) Any and all ejections of patrons;

3) In the event that crime or serious disorder is, or appears to have been, committed on the premises, the management will immediately ensure that:

- (a) The police and, where appropriate, the London Ambulance Service, are called immediately;
- (b) As far as is safe and reasonable practicable, all measures will be taken to apprehend any identified suspects pending the arrival of the police;
- (c) As far as is safe and reasonable practicable, all measures will be taken to preserve any identified crime scene pending the arrival of the police.

4) The licence holder will at all times maintain adequate levels of staff and security. Such staff and security levels will be disclosed, on request, to the Licensing Authority and the Police. At all times that the premises is open to the public for the LNR hours there will be a minimum of 2 members of staff on duty.

a/ The need for door supervisors will be assessed by way of risk assessment and cognisance will be taken of any police advice .

5) The licensee shall ensure, as far as is safe and reasonably practicable to do, that all disorderly persons are not admitted, and if such persons do enter they are promptly removed from the premises.

6) The licensee shall ensure that all staff are trained on relevant matters , including the conditions of the premises licence, managing conflict and the health and safety of the public and staff and [if they are ever left in charge of the premises] the operation of the CCTV system and how to deal with visits from authorised officers. The licensee shall keep written records of training and instructions given to each member

of staff, detailing the areas covered to include the Licensing Objectives .Staff shall sign to confirm that they have received and understood the training. All staff who work at the premises will be trained for their role on induction and be given refresher training every six months. The written training records kept for each staff member will be produced to police & authorised council officers on request.

7) The licensee shall maintain a fully equipped first aid kit on the premises at all times to which staff will have access. All staff shall be aware of its location and make it available for use as and when required.

8) There shall be no motorised deliveries of take-away food or drink from the premises at any time.

I hope that you are happy with the proposed conditions and the wordings given.

I will be in liaison with your council licensing officer Carol Jones, who I have copied in so that they are aware of my visit and initial police representations and your intention to try and obtain the current licence in place at the premises where Mahrous has said you would likely be happy to incorporate police recommendations re updating and safeguarding if that could be achieved [they would be the same 8 conditions as above].

As currently this application is outside of framework hours and timings I think that Police would welcome you agreeing the conditions proposed [which I believe would be suitable for a framework hours new application] but may refer your application after that by way of objection to a Licensing Committee to determine the application having listened to your reasons and mitigations in person for being outside of the framework hours and the police view that this would increase the risk of crime and disorder.

Please reply by e-mail with your agreement to these police initial representation should that be your wish once you have considered them and sought any advice or clarification that you wish. Please indicate in any e-mail if you are reducing the hours applied for.

I would of course be very happy to discuss or clarify any queries or reservations you may have.

I would also be happy to meet with you on site if required and speak personally with Mahrous if you are still abroad in Afghanistan.

This application is obviously time sensitive so a prompt response would be appreciated. The date for last representations is 12/08/23.

I look forward to your response.

Kind Regards,

Tim

Tim Livermore | Constable | Islington Borough – Licensing Team

Address Islington Police Station, 2 Tolpuddle Street , Islington , London N1 0YY

T07721444695 and **Email** Tim.J.Livermore@met.police.uk

Rep 3

From: REDACTED

Sent: 06 August 2023 15:32

To: Licensing <Licensing@islington.gov.uk>

Subject: Naar, 94 Old Street EC1 Objection to planning application.

To whom it may concern.

I would like to object to the application above.

In terms of antisocial behavior, particularly late at night, we have a constant procession in the street of people leaving local licensed premises causing significant noise disturbance, leaving litter and in some cases, I behave in a very aggressive manner so that I myself tend to avoid being out of the house beyond 11 pm if possible. Most of our problems in the street are caused late at night and the hours of opening of these premises should not be extended. They should not be later than 22.30pm Monday to Saturday.

The proposed hours would allow even more people to be coming onto the street after 00.00 on Friday and Saturday, which are largely the worst nights of the week and would attract drinkers who have already been in public houses and who congregate in the churchyard at St Lukes.

Currently due to cost savings by Islington the Church yard and garden of St Lukes, directly opposite these premises on Old Street has become a stopping off point for drunks and drug takers from after the pubs and clubs close. Groups of men who are aggressive and shouting. Most weekends from 4 am - sometimes 7 am Groups drinking and taking drugs, playing music, smashing glasses has become a terrible problem. I myself have had to call the police and I understand the venue applying for this licence has also had to call the police due to trouble from people in the church yard. I have also written to my local councillor without luck so far.

This is intimidating and depressing. I would not dream of leaving the house in the early hours to walk my dog or to jog. I cannot walk my dog early anymore as the left over bottles and food and gas canisters are strewn everywhere. See attached photos from this weekend only.

There is already a high level of disorder on the street late at night particularly on Friday and Saturday nights. People who are drunk or well on the way to it all too often pass by making considerable disturbance and being quite aggressive particularly after the pubs close.

The free availability of alcohol at late night clearly encourages this. The 24 hour off licence is clearly selling alcohol to people who are already drunk in contravention of their licence.

The prevention of public nuisance.

I have already described the type of public nuisance in terms of noise and behavior we regularly have particularly on Friday and Saturday nights up to and beyond midnight. How families with children in, for example, Coltash Court can get them to sleep before midnight or later on any nights in the week except Sunday I do not know.

Turning these premises into an early morning opening venue, Friday and Saturdays

cannot fail to magnify this problem. It will just add to the problems by drawing in customers who have to leave the pubs and clubs.

Public safety - protection of children from harm

The public safety considerations are self-evident from the situation late in the evenings that I have described. This is an area already saturated with licensed premises supplying, adding the availability of food would just mean them hanging around longer and throwing the rubbish from the food everywhere.

Children may very well be harmed by the remains of the drug taking and the broken glass strewn everywhere.

The venue itself is guilty of leaving loads of boxes and bags of rubbish outside their own premises. They also have tables and chairs outside their premises without a license to do so. They are hardly the best to encourage good behaviour from their customers since they do not comply themselves.

Regards
REDACTED

Rep 4

From: REDACTED

Sent: 12 August 2023 23:16

To: Licensing <Licensing@islington.gov.uk>

Subject: Licence Application - Naar, 94 Old Street, EC1V 9AY

Hi there,

Please find below my comments about this application:

Your reference: WK/230018568

Name: REDACTED

Interest: Resident

Address: REDACTED

I think that extending the opening hours - especially until 3am at weekends - would contribute to increased levels of disorder and public nuisance. With the current opening hours, the restaurant already attracts a certain amount of intoxicated and often noisy late-night customers. There can be groups of people loudly talking, or shouting, as customers loiter outside in the street, and across the road in the church garden (which is currently left open all night). I moved in here knowing that the restaurant is there, and I made myself aware of the current opening hours before moving in, and accepted them as a part of living in a Central London location. I also understand of course that people on their way home from a night out are part of Naar's customer base. But I have had to start wearing earplugs for sleeping to reduce the noise, and despite that I am still regularly woken up by Naar's customers. However, a 3am closing time at weekends would very likely attract customers who are (generally speaking) even more intoxicated and/or rowdy and it would encourage

people on a night out in nearby Shoreditch to pass this way, once word gets around about the 3am opening. I believe this would have a cumulative impact. There are many residential units above the restaurant and in the surrounding buildings that are likely to be affected by extended opening hours. Being woken up occasionally late in the evening affects local residents' quality of life much less than potentially being woken up repeatedly until 3am in the morning.

I would prefer to remain anonymous, as the entrance to my building is REDACTED to the restaurant, and with my full address and with my unusual surname, I could easily be identified, which makes me anxious about any tensions or awkwardness. Should that not be possible, I would ask that you at least consider publishing my comments without my flat number.

Best wishes,
REDACTED
Tel: REDACTED

Rep 5

From: REDACTED
Sent: 15 August 2023 17:44
To: Licensing <Licensing@islington.gov.uk>
Subject: Objection - Licensing Application

Hello,

I hope you are well.

It has been brought to my attention that a business owner has applied for opening hour extension and also a license to sell alcohol.

The business is:
Naar Lebanese takeaway
92 Old Street, EC1V 9AY

I live in REDACTED and my window is REDACTED. We are also facing St Luke's church and the park, which remains open during the night.

There is already asbo throughout the night; urinating, drinking, drugs, shouting, that keep us up many nights.

I haven't been able to locate the form to document my objection. Would you be able to forward the form to me or record my objection using the contents of this email?

I'd be grateful if you could help me.

Kind regards,
REDACTED
REDACTED
Phone: REDACTED

Licensing Act 2003 representation pro-forma

Should you wish to comment on the licence application please use this form to help you. Please feel free to attach additional sheets.

You do not have to make any comment, and comments may be made in support of as well as against the application, providing they refer to one or more of the licensing objectives (please see the guidance notes for further advice).

Premises Name and address: Naar, Basement And Ground Floor, 94 Old Street, Islington, London, EC1V 9AY

Your Name: _____

Interest: Resident and Business. _____

(E.g. resident, business, TRA Chair, Councillor, solicitor)

Your Address: _____

Email: _____

Telephone: _____

Please comment on the licensing objectives below relevant to your concerns or observations, you may also wish to include suggestions how your concerns could be addressed:

<p>Public Nuisance</p> <p>As noted in your letter, the premises is within the Bunhill Cumulative Impact Area of Islington in which there are already more licensed operations than necessary. These are usually the cause of noise, and sometimes alarming disturbance at night both during the week and at weekends.</p> <p>General noise from the restaurant may be heard through the adjoining wall of 94 Old Street and our property. At present this stops around 23.00 but a later license would impact on our quiet enjoyment and sleep.</p>
<p>Crime and Disorder</p> <p>Islington police have long maintained that Islington has as unusually high rate of alcohol related crime and regard this part of the borough as a hot-spot. They consider it to be part of a 'Saturation Zone' and profess to resist expansion of licensed trades in the area.</p>

Protection of Children from Harm

Public Safety

Environmental and public health and safety issues here include noise and disturbance, unpleasant and threatening behaviour, dangerous discarded broken bottles, glasses and cans on the streets, pavements and public planter displays, together with urination in our streets and doorways.

I wish my identity to be kept anonymous: Yes / No

We will treat representations as anonymous where there is a genuine reason to do so; if you wish your name and address details to be withheld then please explain the reason:

[Empty box for explanation of reason for anonymity]

Copies of this representation will be sent to the applicant, or their agent/solicitor, including name and address details (but other personal contact information such as telephone numbers and email addresses will be removed) unless you have specifically requested anonymity. Copies of this representation will be included in a report that will be available to the public and will be published on the internet; however, the published on-line version of the report will have name and address details removed.

Signature: _____ Date: 03 August 2023

Please ensure name and address details completed above

Return to:

Licensing Service
Licensing Team, Islington Council, 3rd Floor, 222 Upper St, London, N1 1XR.
Or by email to: licensing@islington.gov.uk



[w](#) [redacted]

Licensing Service
LB of Islington
222 Upper Street
London N1 1YA

11th August 2023

Dear Sirs

Your ref: WK/230018568

**LICENSING ACT 2003 NEW PREMISES APPLICATION
RE: NAAR, BASEMENT AND GROUND FLOOR, 94 OLD STREET
LONDON EC1V 9AY**

OBJECTION from [redacted]

- 1 This objection is to the proposed application for late night refreshment beyond midnight on Friday and Saturday. My wife and I together own the freehold of the whole building at [redacted] including the [redacted] [redacted]. Between us we have lived here since 1993. We have known the applicant premises for all that time and have not had too much of a problem with their customers arriving and causing some noise disturbance by parking outside our flat to get a takeaway from them, up to their present closing time of midnight. Extending their hours to 3am on Saturday and Sunday mornings would be a considerable problem for us.

Effect of the proposed development on public nuisance and disorder

- 2 █ and the other residential premises at this end of Whitecross Street are particularly affected by any noise nuisance. Whitecross Street is narrow at this point and noise is reflected off the sides of the buildings and amplified. This means, for example, that it is possible to hear conversations in the street even when conducted at normal level. One of the main problems is people arriving by car and parking, making a noise, slamming car doors, car radio playing loudly etc. to go for a short period into Old Street as well as people on foot for the same purpose.

- 3 The near presence of Old Street a few yards away, also brings with it similar noise disturbance of people walking along the road and crossing on the light controlled crossing opposite St Luke's, in the gardens outside St Luke's and of course, traffic noise including people arriving or leaving and temporarily parking vehicles in our street or on Old Street, to visit commercial premises particularly late at night. Until our current problems with respect to the use of St Luke's gardens by people causing disturbance during the night including drunks and drug takers, this would at least tail off after the local licensed premises cafes and restaurants in our street and nearby on Old Street closed at 11 pm and the applicant's premises closed at midnight.

- 4 For this reason, we and our neighbours have always opposed the opening hours of nearby café's and restaurants going beyond pub hours and late on Sundays, so as to prevent them being a draw to customers, particularly those who have consumed alcohol, later at night and after the pubs close, thus continuing the public nuisance and disorder that this can cause. See in particular over the last few years, the applications of Elite Café in Whitecross Street and the Korean restaurant █ to our flat.

- 5 Clearly, we do not want to lose this benefit after midnight by the introduction of a new attraction of noise nuisance in the vicinity which could go on till 3 in the morning on Saturday and Sunday. Late night refreshment till 3 am is obviously going to attract people to come either on foot or by car, after normal restaurants and cafes and pubs have closed when otherwise there would be much reduced footfall and traffic. These people, many of whom will have taken alcohol, are very

likely to cause disturbance to us particularly from the arrival and departure of vehicles as well as on foot.

- 6 The applicants have stated to a neighbor, that they will close the seating in the premises and operate as a takeaway after 11pm but this will obviously have no effect on the likely nuisance that attendance at their premises will cause after midnight.
- 7 Also, we do have some respite from all these problems, other than that described in the next paragraph, on Sundays from midnight Saturday as few licensed premises around us are open on a Sunday. We would like to keep it that way as far as possible.
- 8 Further, we now and for some time have had a public order and public nuisance problem coming from the gardens at the front of the restored St Luke's', right opposite the applicant premises and ours as a result of the gardens no longer being cleared of people and locked overnight by Islington Council. We now have people regularly causing a disturbance through the night and into the early hours of the morning playing music and shouting etc. including drunks and drug addicts and the use of nitrous oxide gas every night of the week. The police seem to be often in attendance. Our next-door neighbor had to call them at 4.30am only recently.
- 9 The noise is a disturbance to ours and neighbours' premises and disturbing to sleep. We cannot avoid it even by using a back bedroom. These people seem to be getting their alcohol throughout the night from the Lodos Supermarket at 89/91 Old Street. Late night takeaway to 3 am on Saturdays and Sundays will potentially serve and encourage these people and/or attract even more as well as attracting people from other venues, clubs and pubs, to come to this part of Old Street in the early hours by car and on foot. Ours is perhaps surprisingly, a very residential area. Most of the buildings around us contain flats and residential accommodation, which would be affected.

Prevention of crime and public safety

10. Crime in our area has risen a great deal over the last few years. We often hear disturbances late at night such that we avoid going out of the premises after 11pm. Only a few weeks ago our son (no longer a child) went out to the supermarket across Old Street at about 11pm and had to witness a vicious attack by a group of men on a passing cyclist. One of the few things that can help to prevent this sort of behavior is to make sure that there is nothing in the area to attract people to come here very late at night and in the early hours of the morning.

Protection of children from harm

11. We know from attending other application hearings over the years that the flats adjacent to St Luke's and opposite the applicant premises contain many families with young children. There is a real concern here for an activity that would draw people to this part of Old Street in the early hours of the morning and which as stated above is bound to cause noise and disturbance. Putting up with this till midnight when most premises have closed is one thing but continuing to 3 am is a different matter.

11th August 2023

Appendix 4

From: Abdullah Mohammedi
Sent: 23 August 2023 15:18
To: Jones, Carol <Carol.Jones@islington.gov.uk>
Subject: Naar Lebanese

Dear Resident,

I have been forwarded copies of your representation to my application for a new premises licence.

I think I have met some of you, as you have come into my premises to speak with me or my business partner. If you have not been in to talk to us, please do, as we would be very happy to talk to you and explain our business to you.

In April the Police came in and explained we needed to have a licence for operating at this premises. We thought there was a licence in place, but did not realise at that time that it needed to be in our name. We contacted the Council and made a new application. We misunderstood the Police officer and thought we needed to have our own licence, so we made this application. Please note, the licence is not for alcohol, only for food. We plan to allow people to eat inside our premises until 11pm and then operate 'Take-away' only.

We will be very mindful of the residents and not let our customers make any noise to disturb you. We are also concerned and are being disturbed by the people who sit in the park opposite with music and drinks. So far, they have not come to us for food, we are concerned in case they do. Carol Jones from the Council advises she has contacted the Parks Team in the Council to ask them to lock the gates at night. If the gates were locked, I think it would solve the nuisance, as they wouldn't be able to sit there anymore.

We have been operating Late Night Refreshment premises across London for many years now and hope we have not caused a nuisance to you while we have been at 94 Old Street. We understand your concern, but I have been speaking to the Council and now understand that the licence in place at this premises is for later hours during the week, than the hours we have asked for and does not contain any conditions. We have also accepted the conditions from the Police and Council, see below;

Conditions proposed by the Licensing Police

- 1) CCTV shall be installed, operated, and maintained, to function all times that the premises is open for licensable activities. Said CCTV will comply with the following criteria:
 - (a) The licensee will ensure that the system is checked every two weeks to ensure that the system is working properly and that the date and time are correct.
 - (b) A record of these checks, showing the date and name of the person checking, will be kept and made available to the police or other authorised officer on request;
 - (c) The Police will be informed if the system will not be operating for longer than one day of business for any reason;
 - (d) One camera will show a close-up of the entrance to the premises, to capture a clear, full length image of anyone entering;
 - (e) The system will provide full coverage of the interior of the premises and any exterior part of the premises accessible to the public;
 - (f) The system will record in real time and recordings will be date and time stamped;

(g) At all times during operating hours, there will be at least 1 member of staff on the premises who can operate the system sufficiently to allow Police or authorised Council officers to view footage on request.

(h) Recordings will be kept for a minimum of 31 days and downloaded footage will be provided free of charge to the police or other authorised officers on request (subject to the Data Protection Act 2018) within 24 hours of any request.

(i) Signage stating that CCTV is in operation will be clearly and prominently displayed at the premises.

(j) The use of CCTV at the premises shall be registered with the Information Commissioners Office [ICO].

2) A premises incident log or book shall be kept at the premises, and made available upon request to the police or an authorised officer, which will record:

(a) Any and all allegations of crime and/or disorder reported at the venue;

(b) Any and all complaints received by any party;

(c) Any faults in the CCTV system;

(d) Any visit by a relevant authority or emergency service;

(e) Any and all ejections of patrons;

3) In the event that crime or serious disorder is, or appears to have been, committed on the premises, the management will immediately ensure that:

(a) The police and, where appropriate, the London Ambulance Service, are called immediately;

(b) As far as is safe and reasonable practicable, all measures will be taken to apprehend any identified suspects pending the arrival of the police;

(c) As far as is safe and reasonable practicable, all measures will be taken to preserve any identified crime scene pending the arrival of the police.

4) The licence holder will at all times maintain adequate levels of staff and security. Such staff and security levels will be disclosed, on request, to the Licensing Authority and the Police. At all times that the premises is open to the public for the LNR hours there will be a minimum of 2 members of staff on duty.

a/ The need for door supervisors will be assessed by way of risk assessment and cognisance will be taken of any police advice .

5) The licensee shall ensure, as far as is safe and reasonably practicable to do, that all disorderly persons are not admitted, and if such persons do enter they are promptly removed from the premises.

6) The licensee shall ensure that all staff are trained on relevant matters, including the conditions of the premises licence, managing conflict and the health and safety of the public and staff and [if they are ever left in charge of the premises] the operation of the CCTV system and how to deal with visits from authorised officers. The licensee shall keep written records of training and instructions given to each member of staff, detailing the areas covered to include the Licensing Objectives .Staff shall sign to confirm that they have received and understood the training. All staff who work at the premises will be trained for their role on induction and be given refresher training every six months. The written training records kept for each staff member will be produced to police & authorised council officers on request.

7) The licensee shall maintain a fully equipped first aid kit on the premises at all times to which staff will have access. All staff shall be aware of its location and make it available for use as and when required.

Conditions proposed by Islington's Noise Team

1. Noise, vibration or odours must not emanate from the premises so as to cause a nuisance to nearby properties.
2. In the event of a noise/ odour nuisance complaint substantiated by an authorised officer, the licensee shall take appropriate measures in order to prevent any recurrence.
3. Prominent, clear and legible notices must be displayed at all exits requesting the public to respect the needs of local residents and to leave the premises and the area quietly.
4. The delivery of licensable goods to the premises shall be restricted to the hours between 07:00 and 23:00 Monday-Saturday. No deliveries of licensable goods to the premises shall be made on a Sunday or Bank Holiday.
5. The collection of refuse shall be restricted to the hours between 07:00 and 23:00 Monday-Saturday. No waste collections shall be made on a Sunday or Bank Holiday.
6. The outside frontage shall be swept and cleared of any rubbish and smoking litter associated with the business towards the end of trade each evening.
7. Any music shall be restricted to ambient background levels of sound.
8. The shutters to the front of the premises shall be maintained so as not to cause a noise nuisance when in operation to residential properties in close vicinity
9. There shall be no more than 5 customers outside the venue smoking.
10. The licensee shall practice best endeavours to ensure that no internal combustion engine vehicles are used for deliveries from the premises.
11. If internal combustion engine vehicles are used for deliveries from the premises, the licensee shall ensure that drivers do not park or loiter in the vicinity of residential premises.
12. The premises will operate a no idling policy for delivery drivers.
13. Delivery drivers will conduct the delivery in a manner that will not cause a noise disturbance to the occupiers of any residential properties surrounding the delivery address.

Please contact us if you would like to meet with us to talk about our application and business.

Kind regards,
Abdullah Mohammedi

Conditions Consistent with the Operating Schedule

Appendix 5

All suggested conditions in the application have been re-worded by the Police and Noise Team

Conditions proposed by the Licensing Police – Agreed

1) CCTV shall be installed, operated, and maintained, to function all times that the premises is open for licensable activities. Said CCTV will comply with the following criteria:

- (a) The licensee will ensure that the system is checked every two weeks to ensure that the system is working properly and that the date and time are correct.
- (b) A record of these checks, showing the date and name of the person checking, will be kept and made available to the police or other authorised officer on request;
- (c) The Police will be informed if the system will not be operating for longer than one day of business for any reason;
- (d) One camera will show a close-up of the entrance to the premises, to capture a clear, full length image of anyone entering;
- (e) The system will provide full coverage of the interior of the premises and any exterior part of the premises accessible to the public;
- (f) The system will record in real time and recordings will be date and time stamped;
- (g) At all times during operating hours, there will be at least 1 member of staff on the premises who can operate the system sufficiently to allow Police or authorised Council officers to view footage on request.
- (h) Recordings will be kept for a minimum of 31 days and downloaded footage will be provided free of charge to the police or other authorised officers on request (subject to the Data Protection Act 2018) within 24 hours of any request.
- (i) Signage stating that CCTV is in operation will be clearly and prominently displayed at the premises.
- (j) The use of CCTV at the premises shall be registered with the Information Commissioners Office [ICO].

2) A premises incident log or book shall be kept at the premises, and made available upon request to the police or an authorised officer, which will record:

- (a) Any and all allegations of crime and/or disorder reported at the venue;
- (b) Any and all complaints received by any party;
- (c) Any faults in the CCTV system;
- (d) Any visit by a relevant authority or emergency service;
- (e) Any and all ejections of patrons;

3) In the event that crime or serious disorder is, or appears to have been, committed on the premises, the management will immediately ensure that:

- (a) The police and, where appropriate, the London Ambulance Service, are called immediately;
- (b) As far as is safe and reasonable practicable, all measures will be taken to apprehend any identified suspects pending the arrival of the police;
- (c) As far as is safe and reasonable practicable, all measures will be taken to preserve any identified crime scene pending the arrival of the police.

4) The licence holder will at all times maintain adequate levels of staff and security. Such staff and security levels will be disclosed, on request, to the Licensing Authority and the Police. At all times that the premises is open to the public for the LNR hours there will be a minimum of 2 members of staff on duty.

a/ The need for door supervisors will be assessed by way of risk assessment and cognisance will be taken of any police advice .

5) The licensee shall ensure, as far as is safe and reasonably practicable to do, that all disorderly persons are not admitted, and if such persons do enter they are promptly removed from the premises.

6) The licensee shall ensure that all staff are trained on relevant matters, including the conditions of the premises licence, managing conflict and the health and safety of the public and staff and [if they are ever left in charge of the premises] the operation of the CCTV system and how to deal with visits from authorised officers. The licensee shall keep written records of training and instructions given to each member of staff, detailing the areas covered to include the Licensing Objectives. Staff shall sign to confirm that they have received and understood the training. All staff who work at the premises will be trained for their role on induction and be given refresher training every six months. The written training records kept for each staff member will be produced to police & authorised council officers on request.

7) The licensee shall maintain a fully equipped first aid kit on the premises at all times to which staff will have access. All staff shall be aware of its location and make it available for use as and when required.

Conditions proposed by Islington's Noise Team- Agreed

1. Noise, vibration or odours must not emanate from the premises so as to cause a nuisance to nearby properties.
2. In the event of a noise/ odour nuisance complaint substantiated by an authorised officer, the licensee shall take appropriate measures in order to prevent any recurrence.
3. Prominent, clear and legible notices must be displayed at all exits requesting the public to respect the needs of local residents and to leave the premises and the area quietly.
4. The delivery of licensable goods to the premises shall be restricted to the hours between 07:00 and 23:00 Monday-Saturday. No deliveries of licensable goods to the premises shall be made on a Sunday or Bank Holiday.
5. The collection of refuse shall be restricted to the hours between 07:00 and 23:00 Monday-Saturday. No waste collections shall be made on a Sunday or Bank Holiday.
6. The outside frontage shall be swept and cleared of any rubbish and smoking litter associated with the business towards the end of trade each evening.
7. Any music shall be restricted to ambient background levels of sound.
8. The shutters to the front of the premises shall be maintained so as not to cause a noise nuisance when in operation to residential properties in close vicinity
9. There shall be no more than 5 customers outside the venue smoking.
10. The licensee shall practice best endeavours to ensure that no internal combustion engine vehicles are used for deliveries from the premises.
11. If internal combustion engine vehicles are used for deliveries from the premises, the licensee shall ensure that drivers do not park or loiter in the vicinity of residential premises.
12. The premises will operate a no idling policy for delivery drivers.
13. Delivery drivers will conduct the delivery in a manner that will not cause a noise disturbance to the occupiers of any residential properties surrounding the delivery address.

Address Search

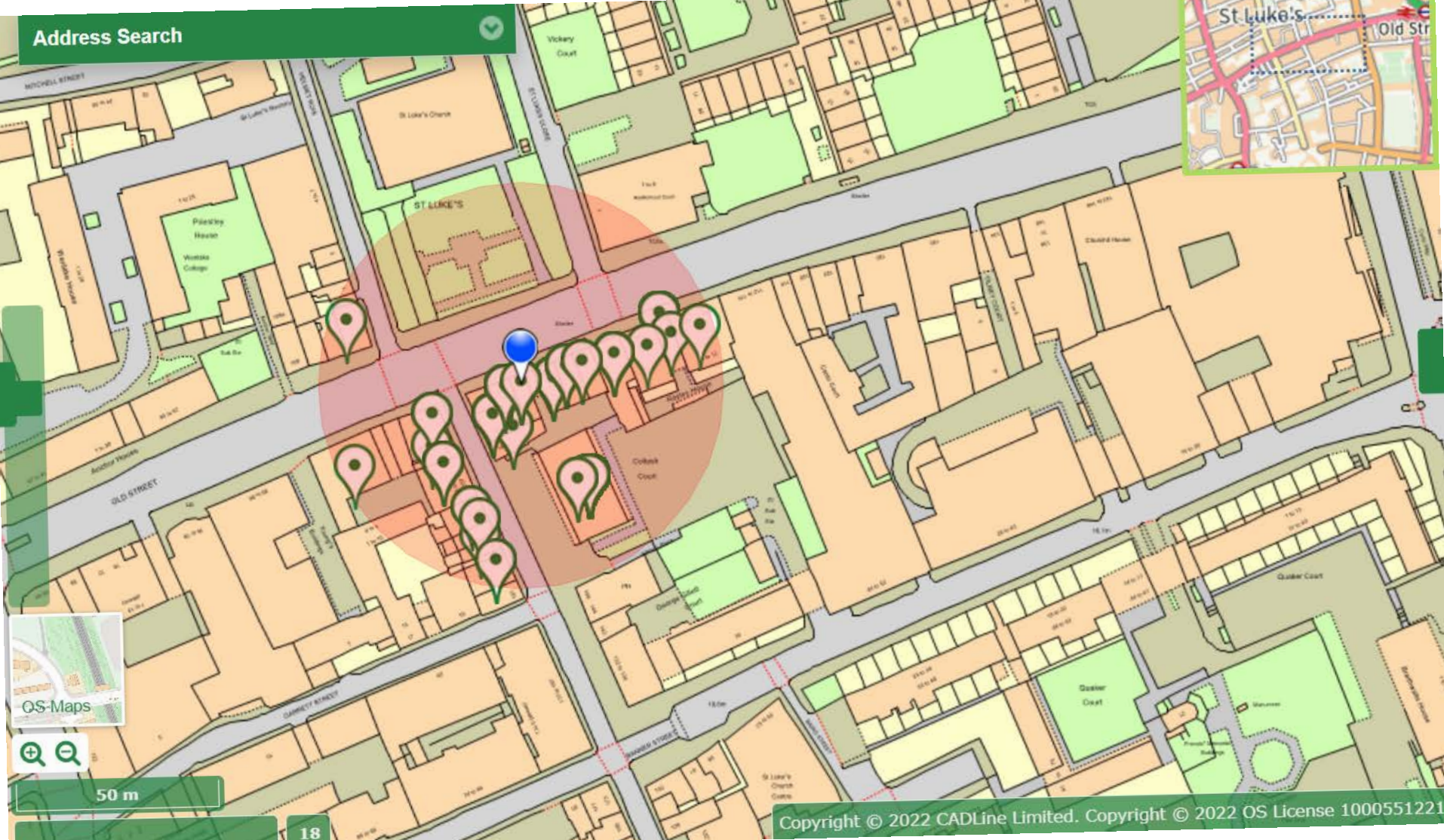

50 m

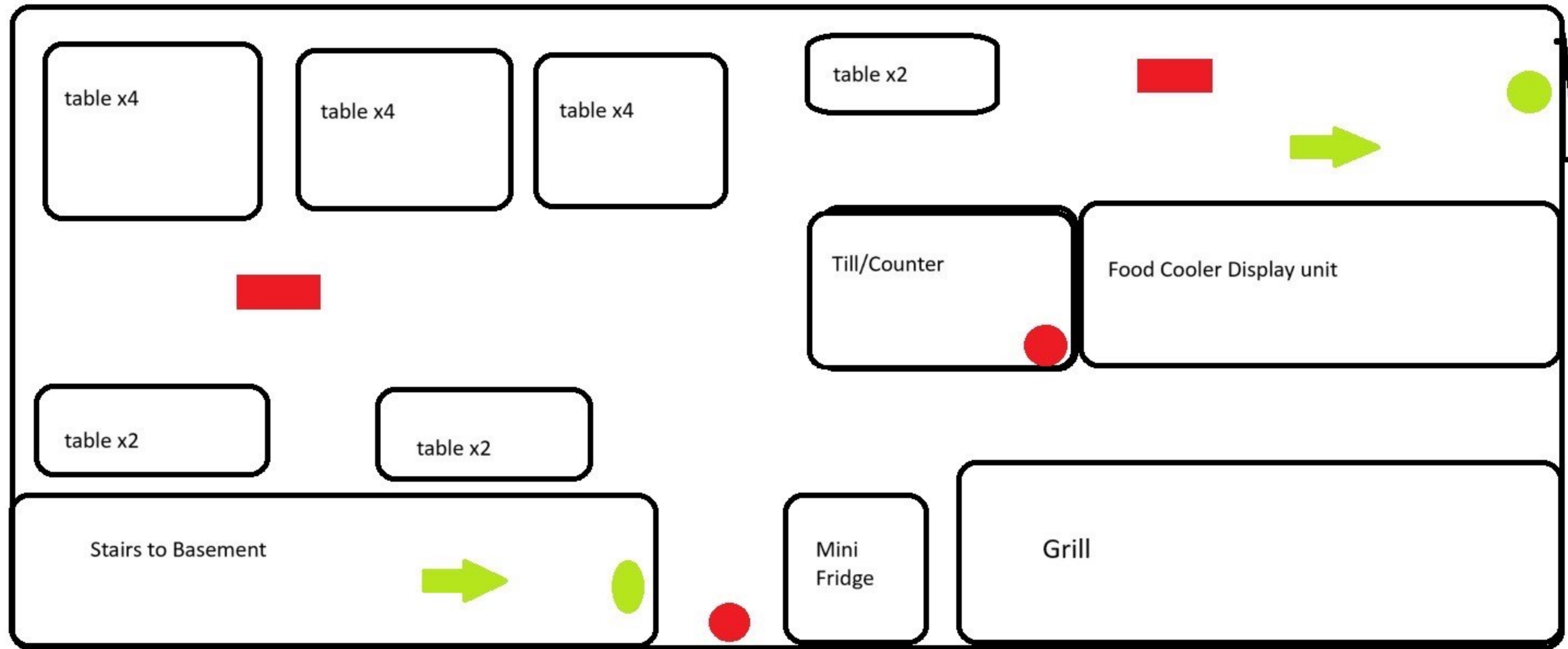

 Fire Alarm

 Fire Extinguisher

 Fire Exit